

Τ.Κ. ΑΓΙΟΥ ΓΕΩΡΓΙΟΥ

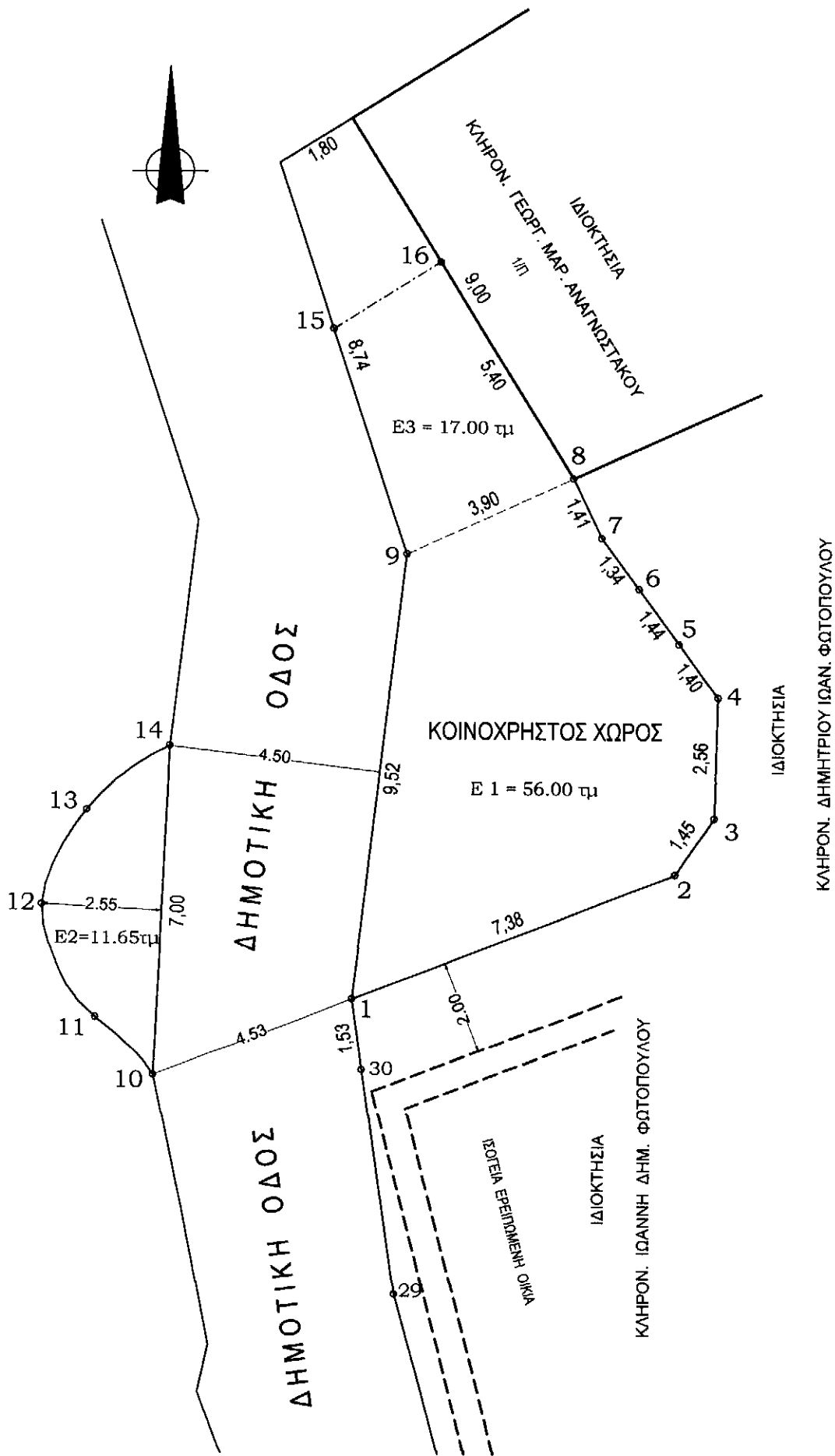

Τ.Κ. ΑΓΙΑΣ ΣΟΦΙΑΣ

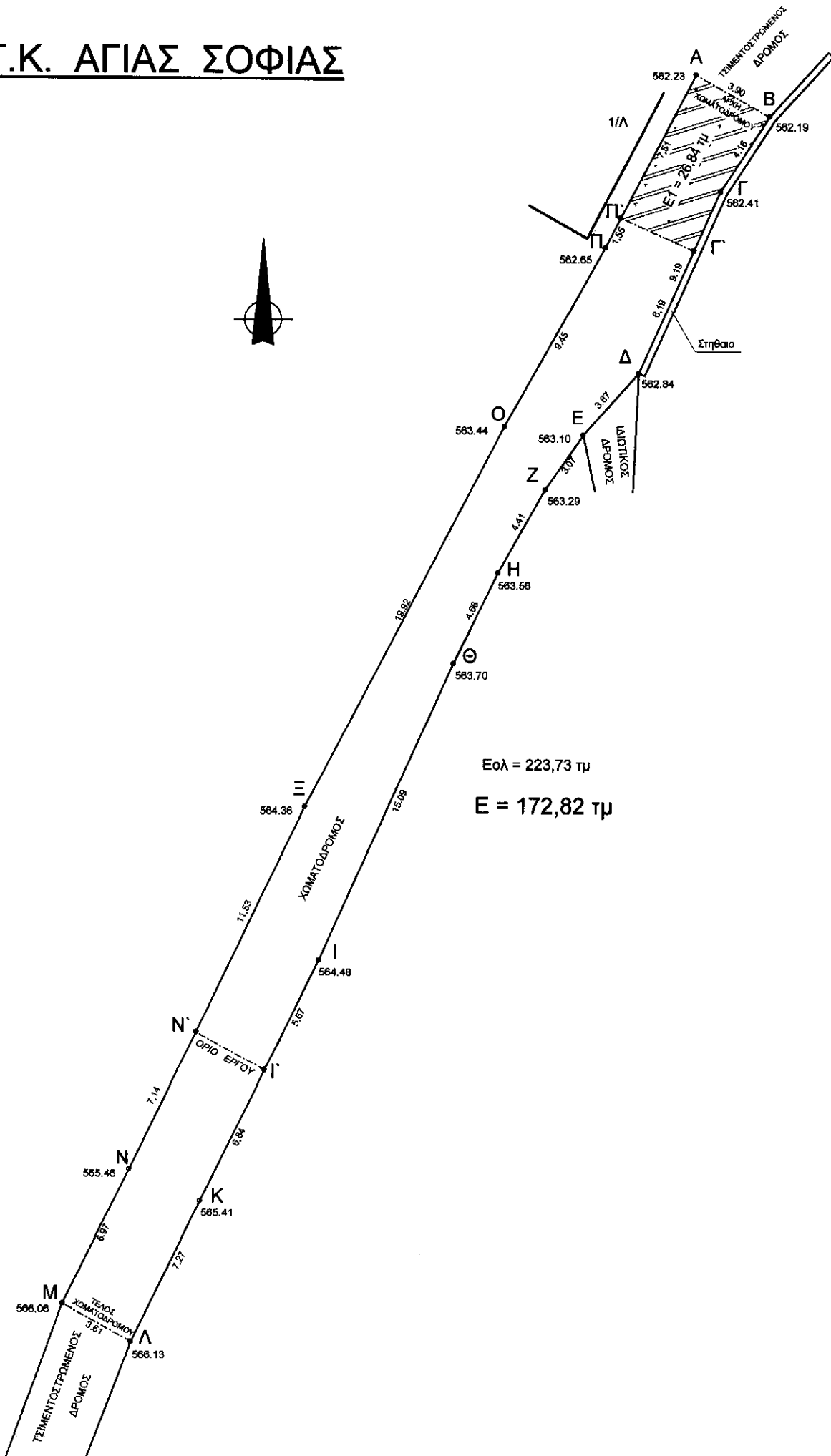
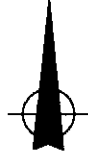

Εολ = 223,73 τμ

Ε = 172,82 τμ

Τ.Κ. ΠΛΑΤΑΝΑΣ

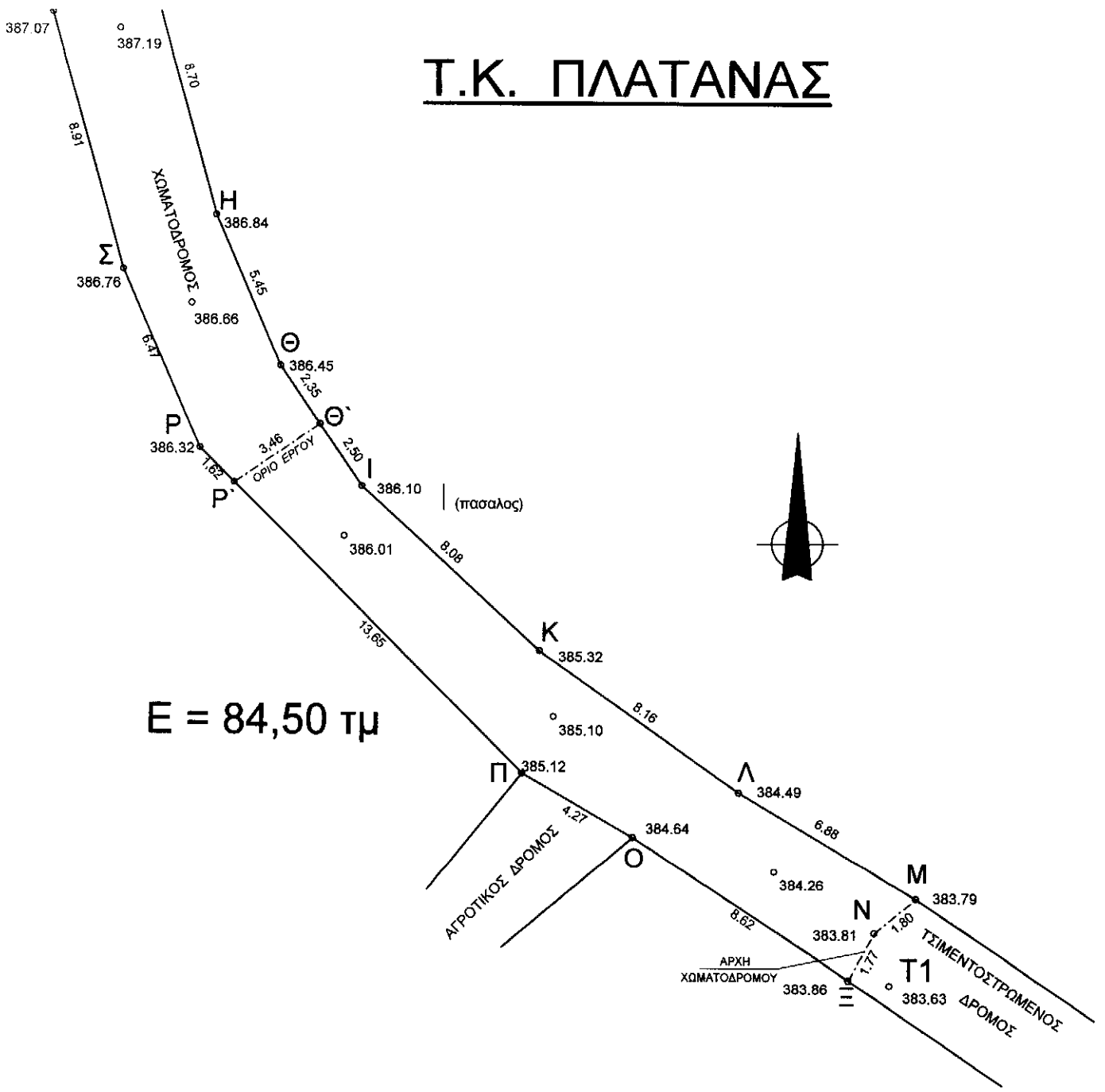



ΔΗΜΟΤΙΚΗ ΟΔΟΣ

Τ.Κ. ΣΤΟΛΟΥ

ΠΡΟΣ ΤΡΙΓΩΛΗ ↑

ΙΔΙΟΚΤΗΣΙΑ :
ΚΛΗΡ. ΣΤΑΜΑΤΙΝΑΣ ΒΑΛΒΗΣ

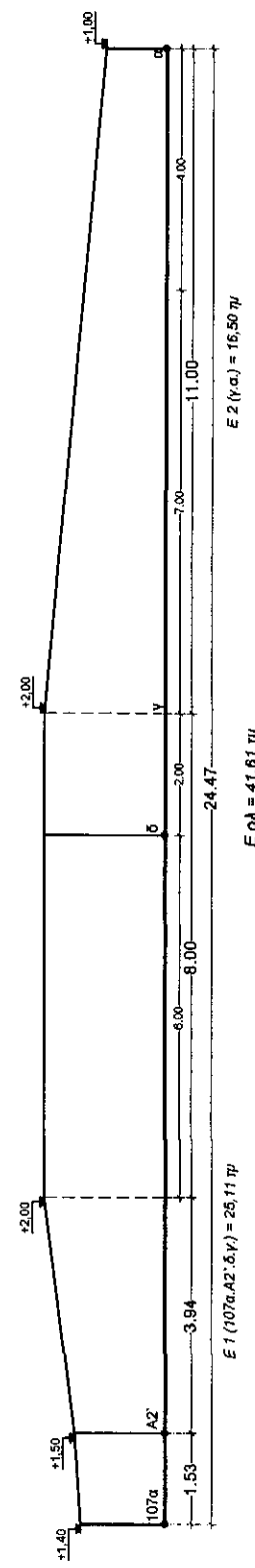
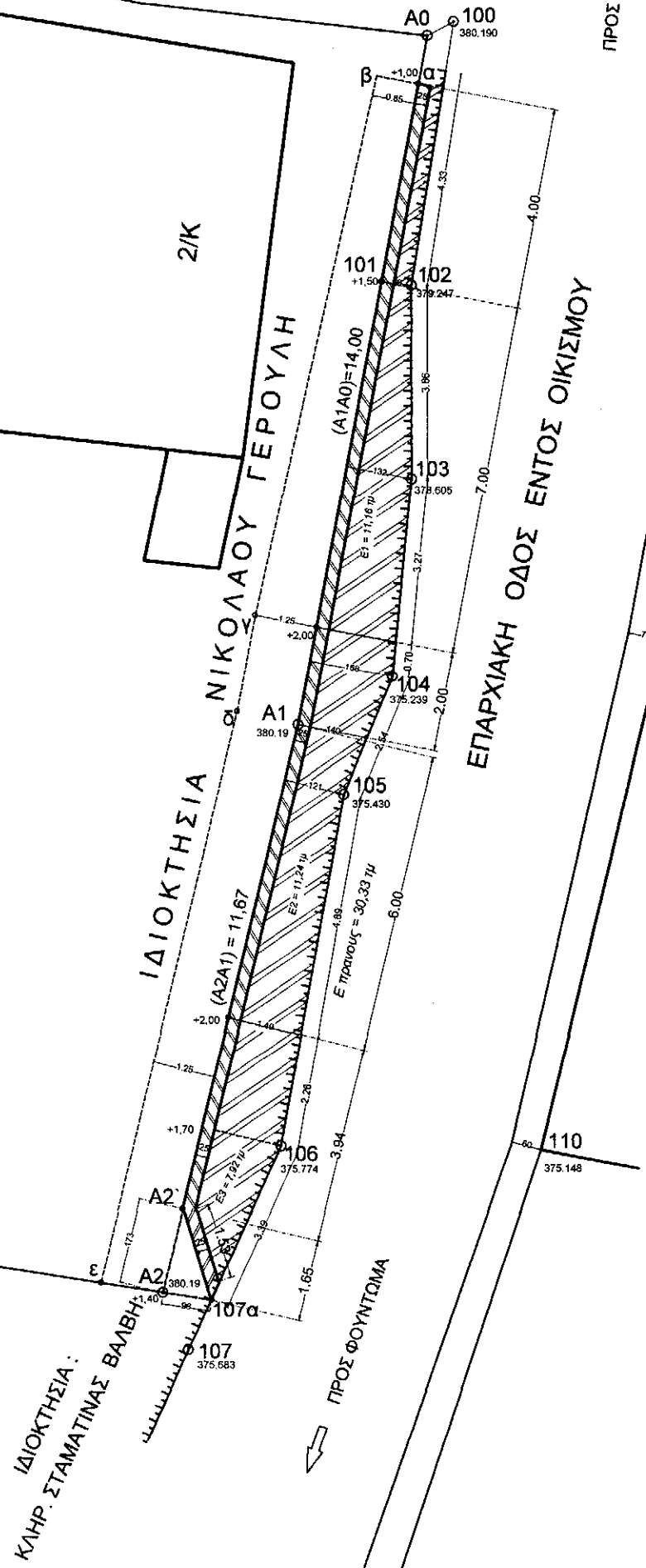

ΟΨΗ ΤΟΙΧΕΙΟΥ

ΤΟΙΧΟΣ ΑΝΤΙΣΤΗΡΙΞΗΣ Τ.Κ. ΣΤΟΛΟΥ

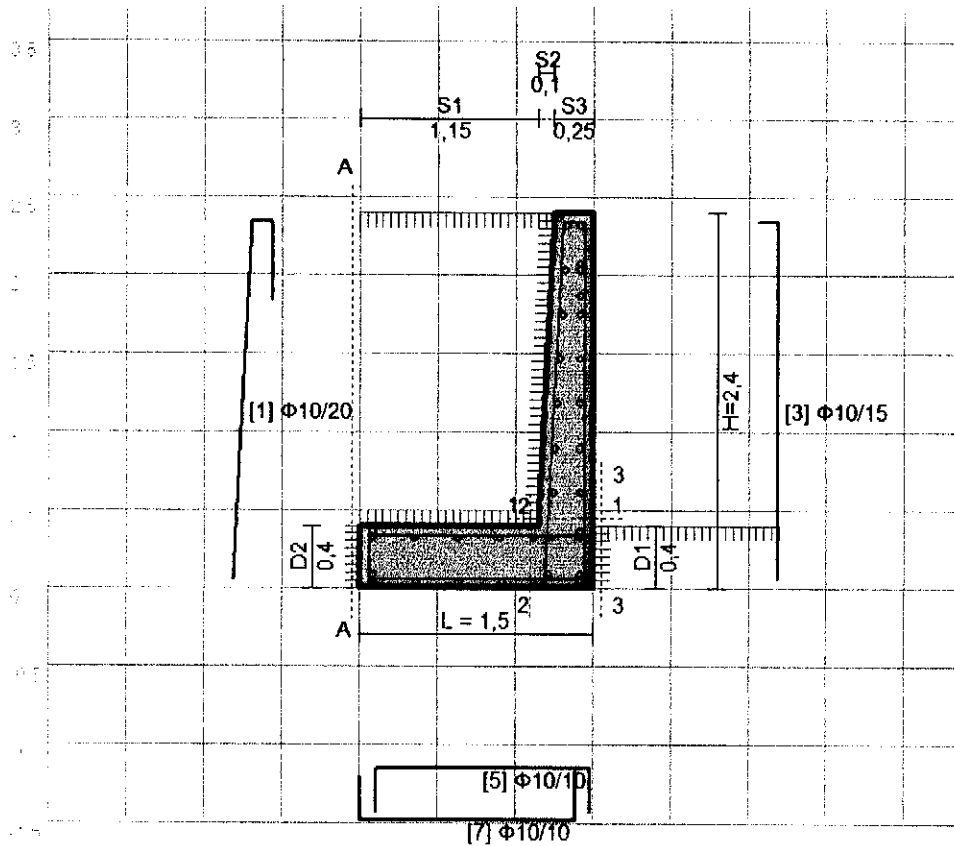

ΤΟΙΧΟΣ ΥΨΟΥΣ 2,00 m

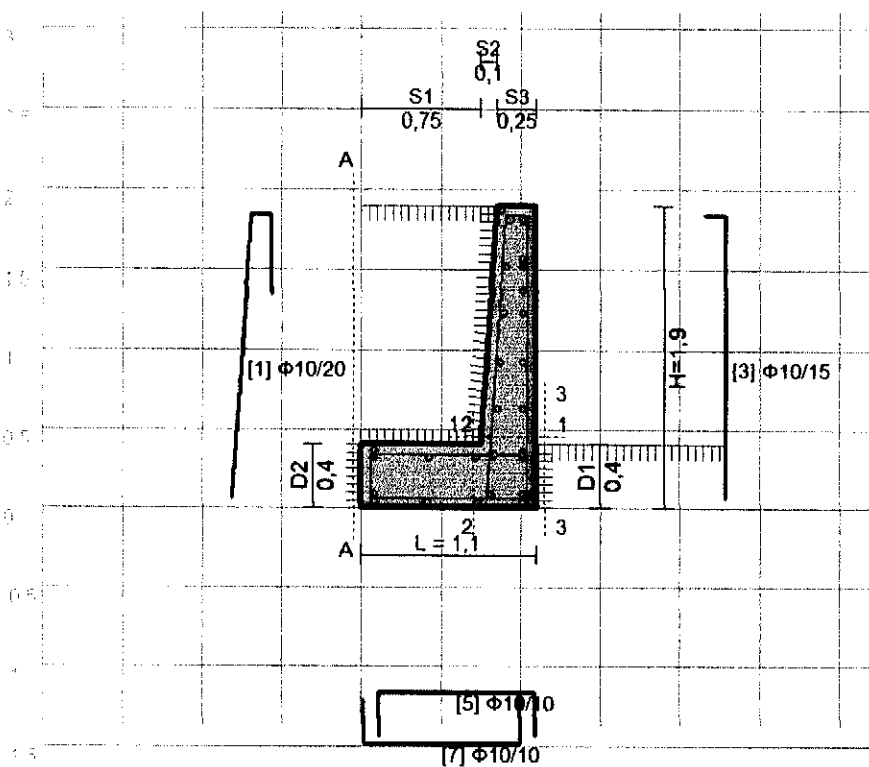

ΤΟΙΧΟΣ ΥΨΟΥΣ 1,50 m

ΠΡΟΜΕΤΡΗΣΕΙΣ

5) Τ.Κ. ΠΛΑΤΑΝΟΥ

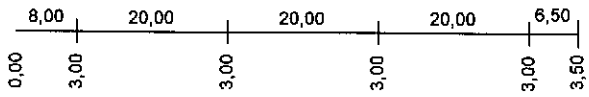

$$E_5 = 213,13 \text{ τ.μ.}$$

10) Τ.Κ. ΜΕΣΟΡΡΑΧΗΣ

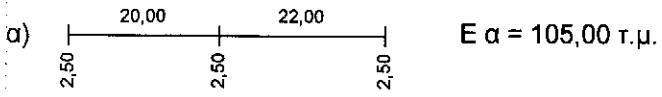

$$E_\alpha = 105,00 \text{ τ.μ.}$$



$$E_\beta = 6,16 \text{ τ.μ.}$$

Τ.Κ. ΧΑΡΑΔΡΟΥ

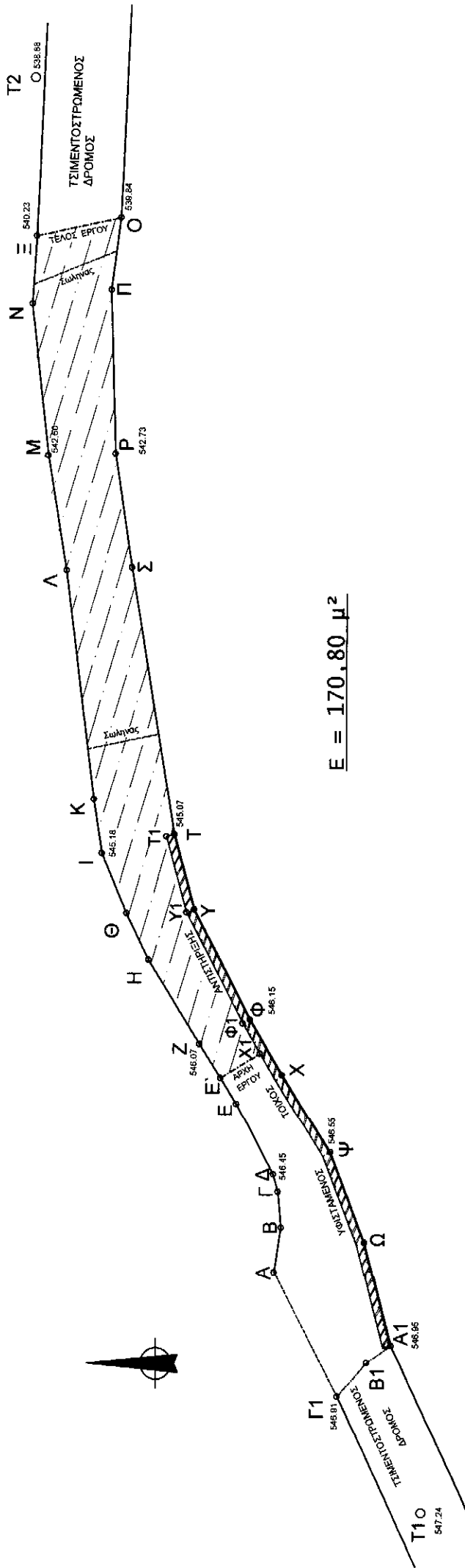

$$E = 170,80 \mu^2$$

Τ.Κ. ΣΙΤΑΙΝΑΣ

(Θέση : Α)

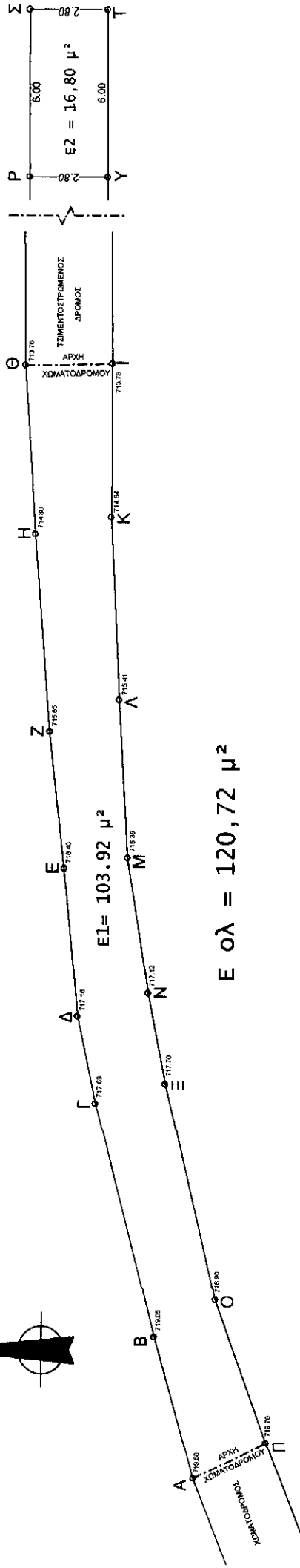
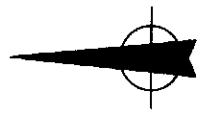

$E \text{ ολ} = 120,72 \mu^2$

Τ.Κ. ΣΙΤΑΙΝΑΣ

(Θεση : Β)

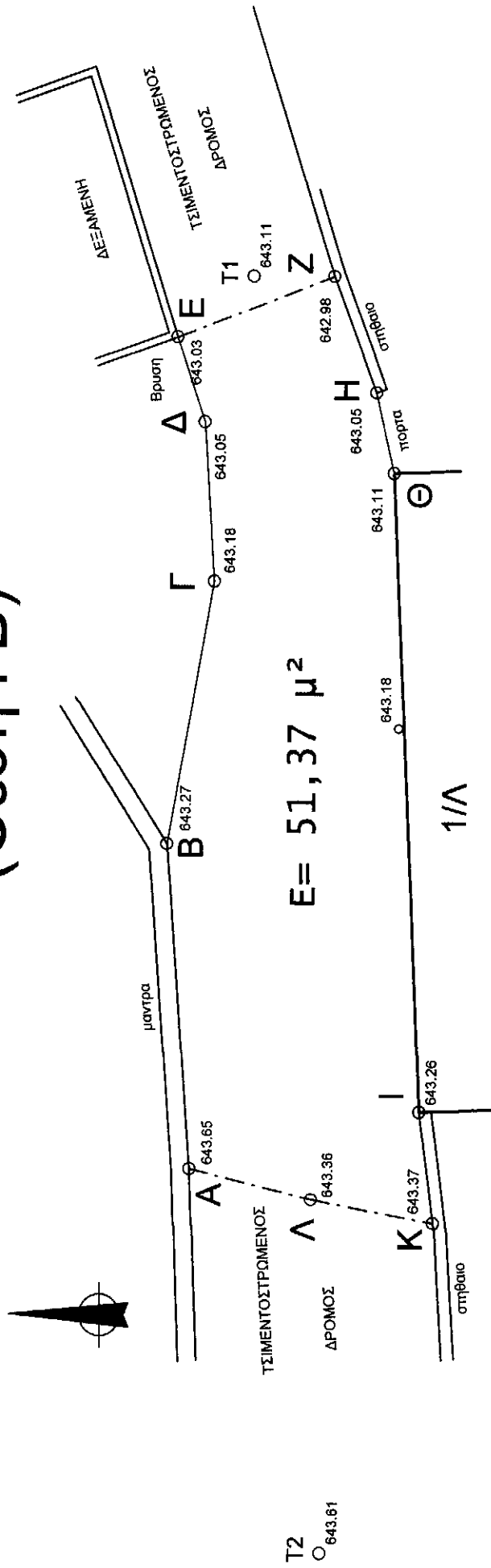

Τ.Κ. ΣΙΤΑΙΝΑΣ

(Θεση: Γ)

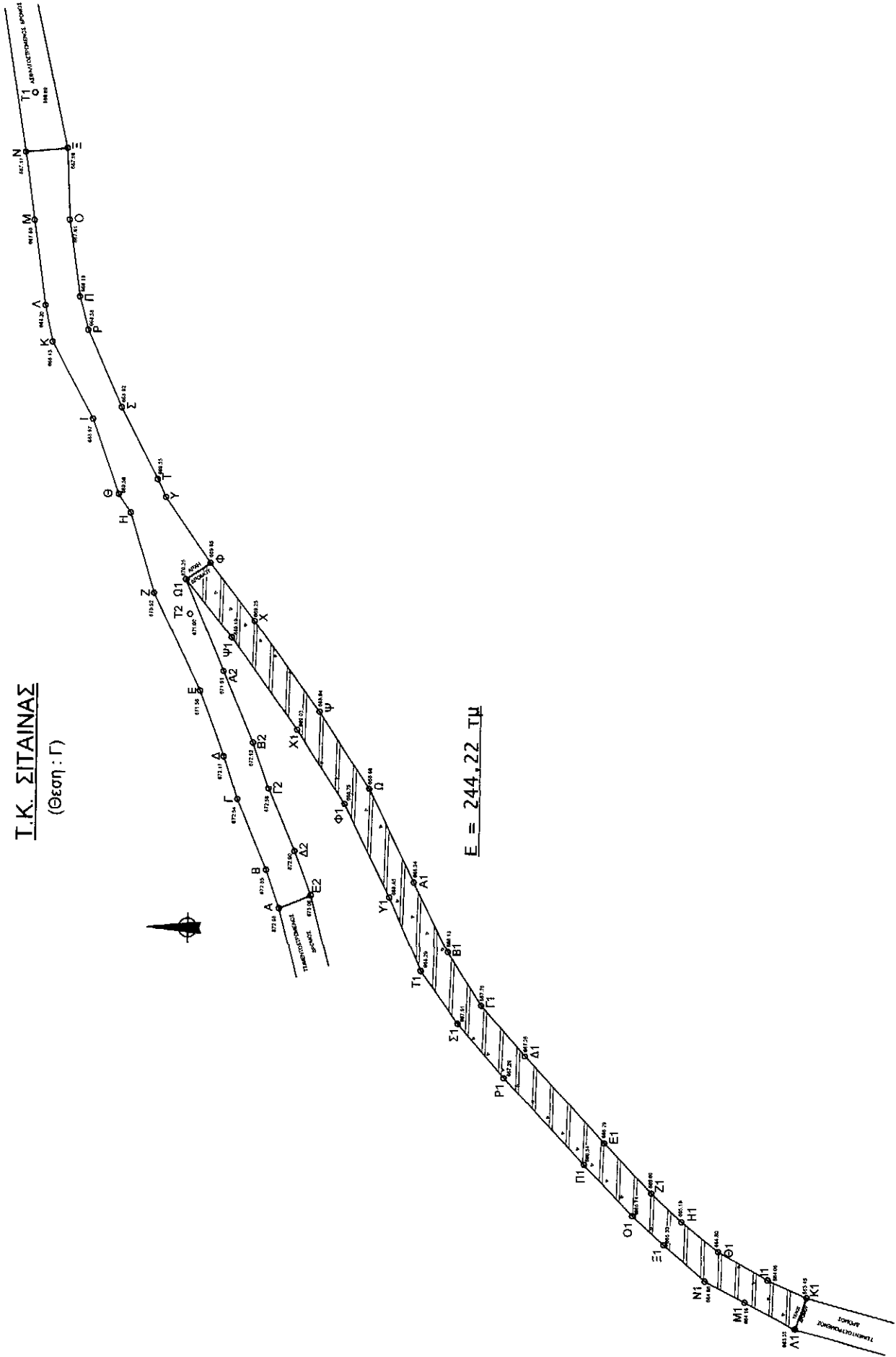

$$E = 244.22 \text{ ΤΜ}$$

Τ.Κ. ΚΑΡΑΤΟΥΛΑΣ

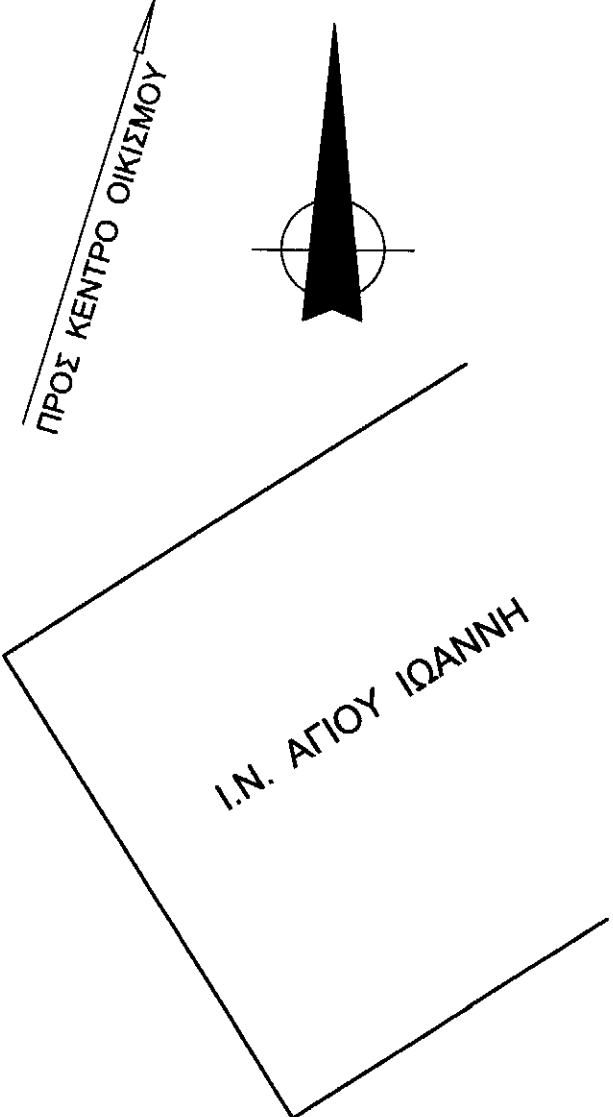
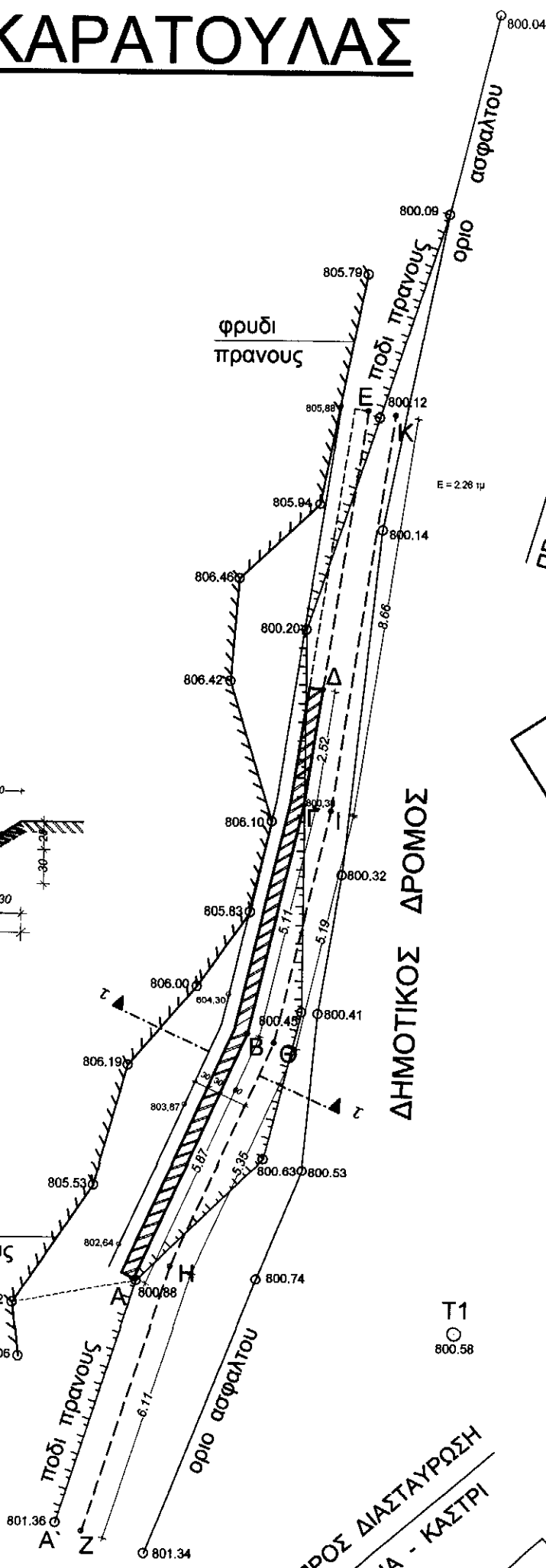
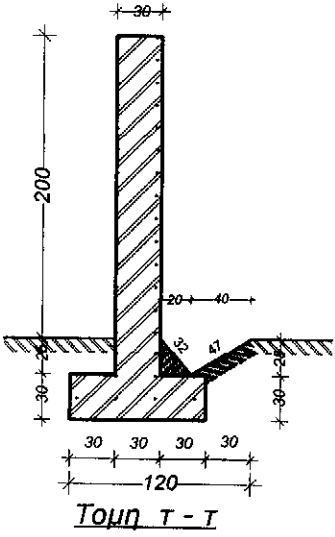

T.K. ΚΑΡΑΤΟΥΛΑΣ

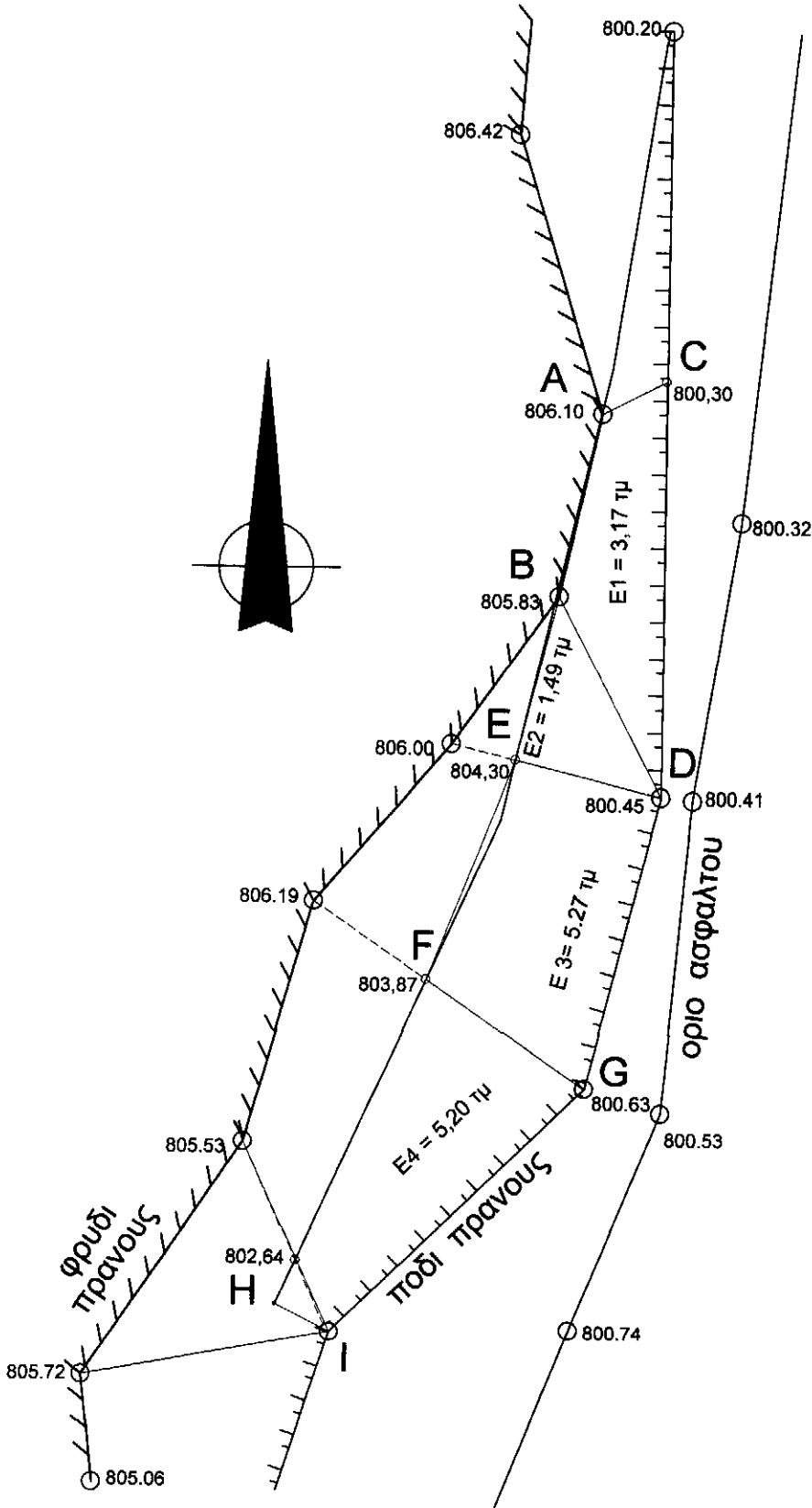
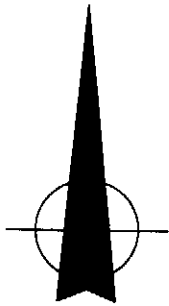

ΔΗΜΟΤΙΚΟΣ ΔΡΟΜΟΣ

Τ.Κ. ΚΑΣΤΡΙΟΥ (Θέση : Α)

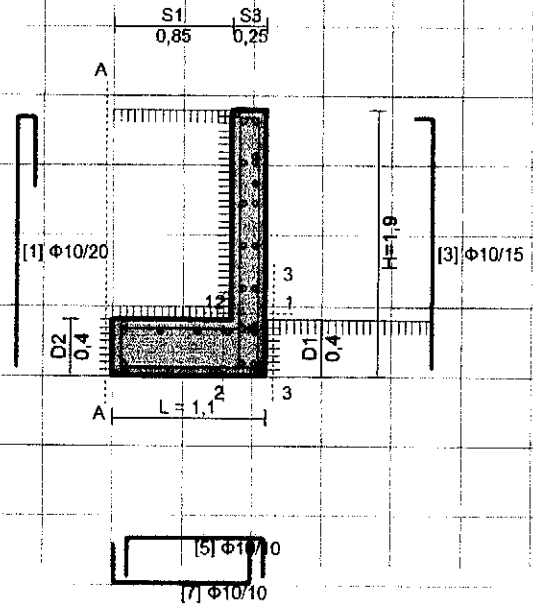

Τ.Κ. ΚΑΣΤΡΙΟΥ (Θέση : Β)

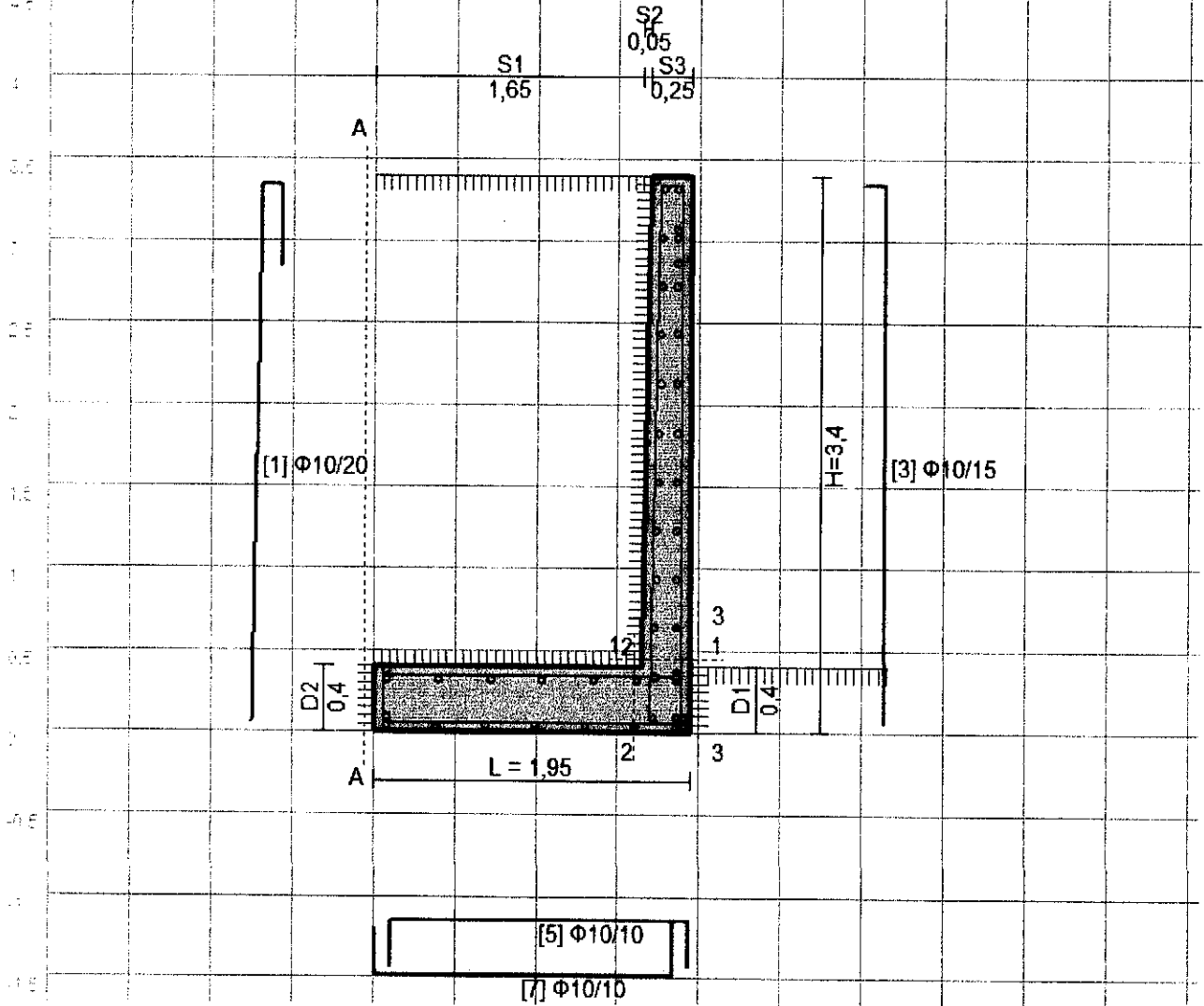

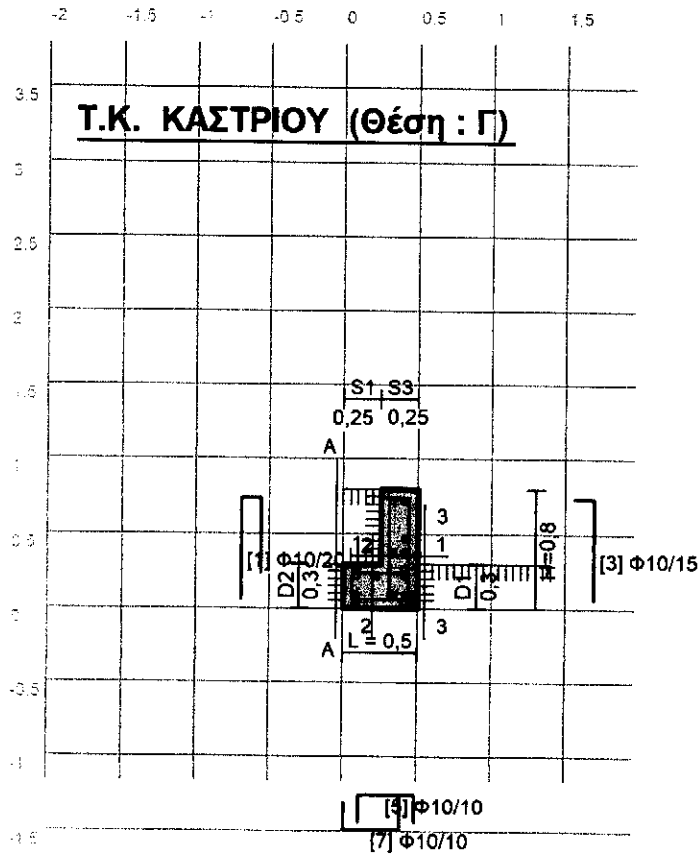

Τ.Κ. ΚΑΣΤΡΙΟΥ

(Θεση : Γ)

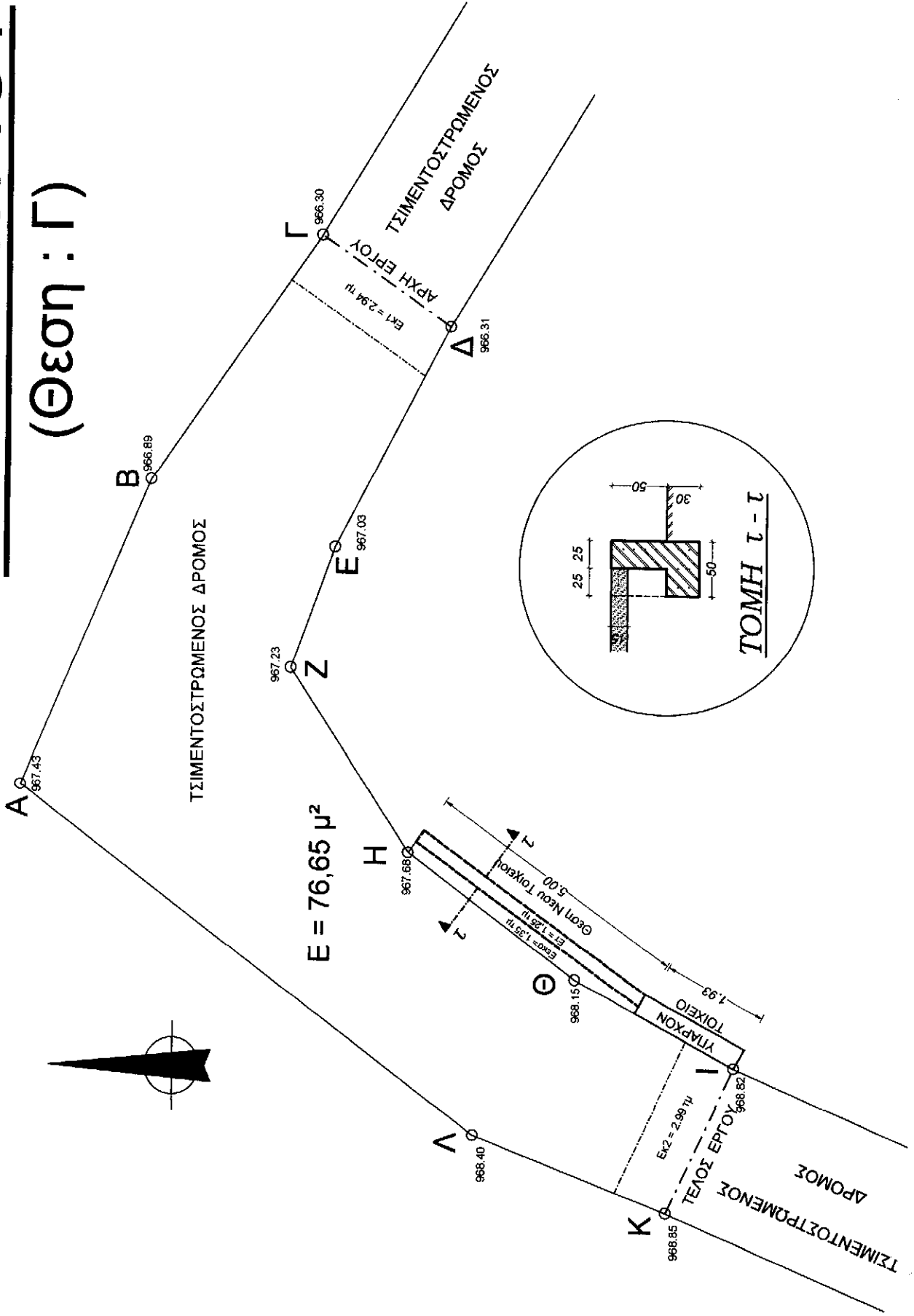

Τ.Κ. ΚΑΣΤΡΙΟΥ

(Θεση : Δ)

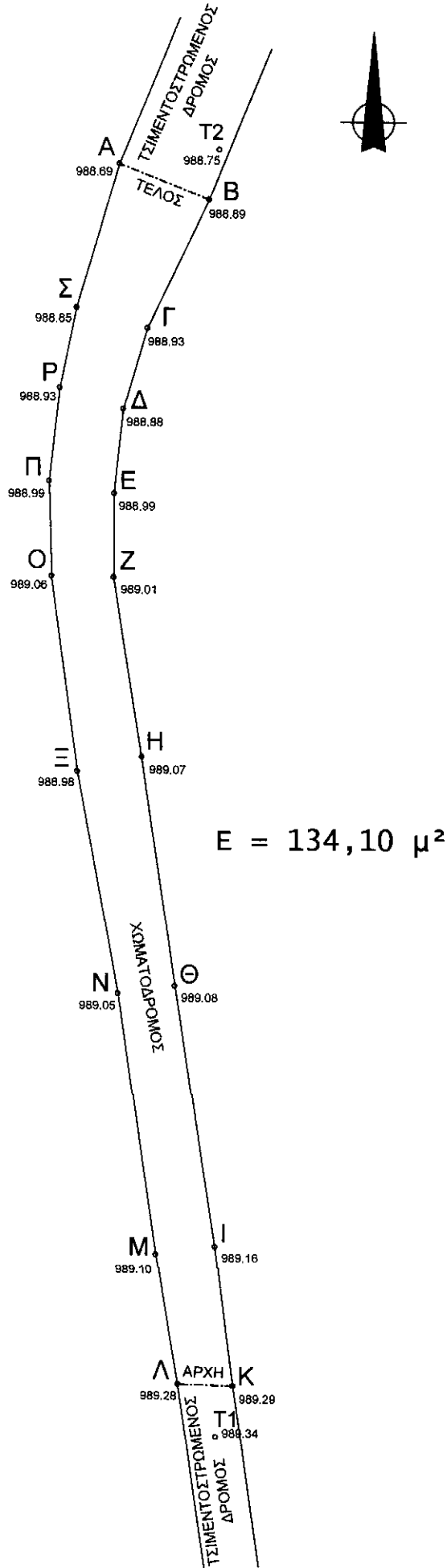

Τ.Κ. ΚΑΣΤΑΝΙΤΣΑΣ

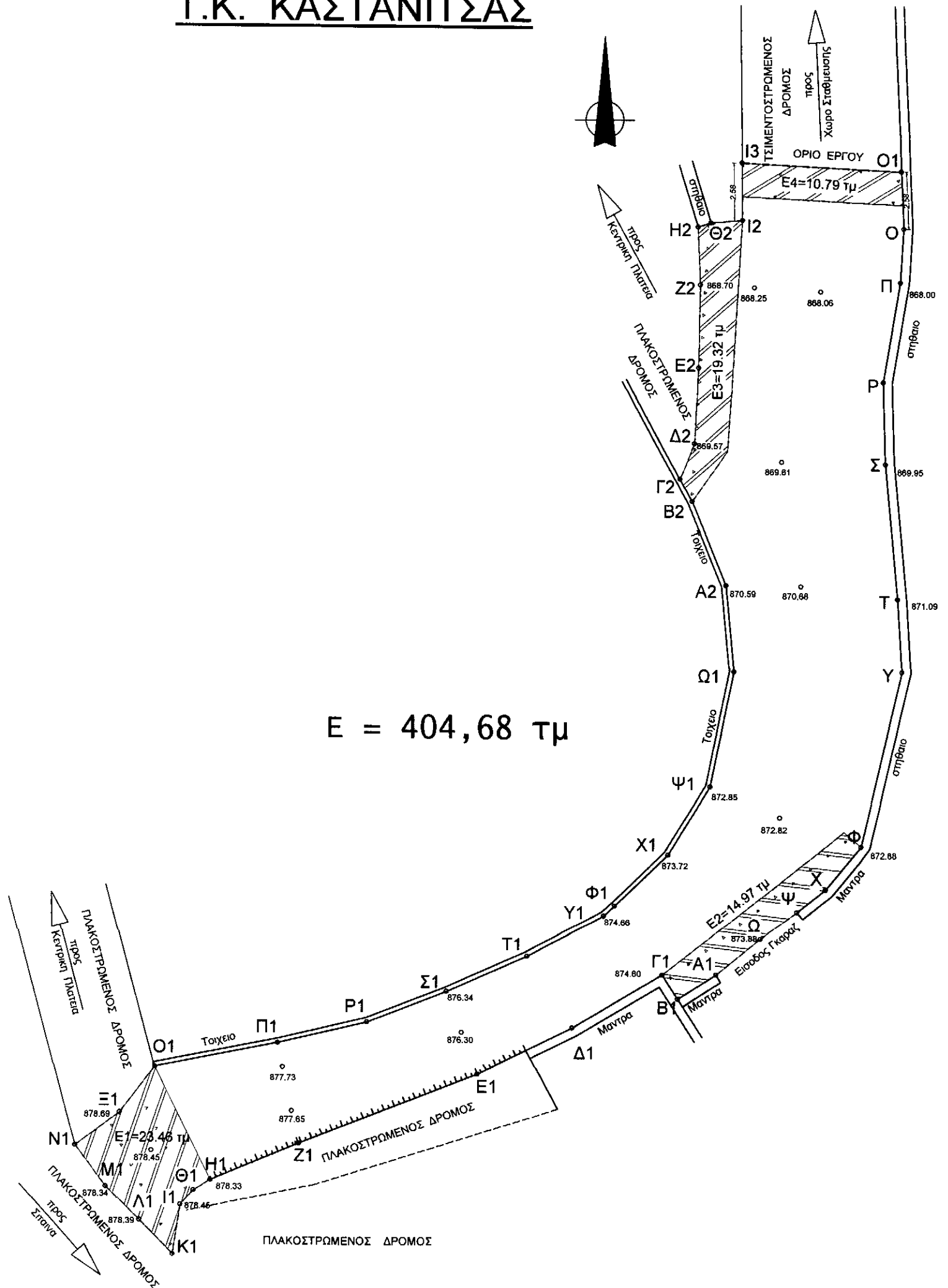
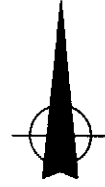

$E = 404,68 \text{ τμ}$